

PLANTA DE LOCAÇÃO

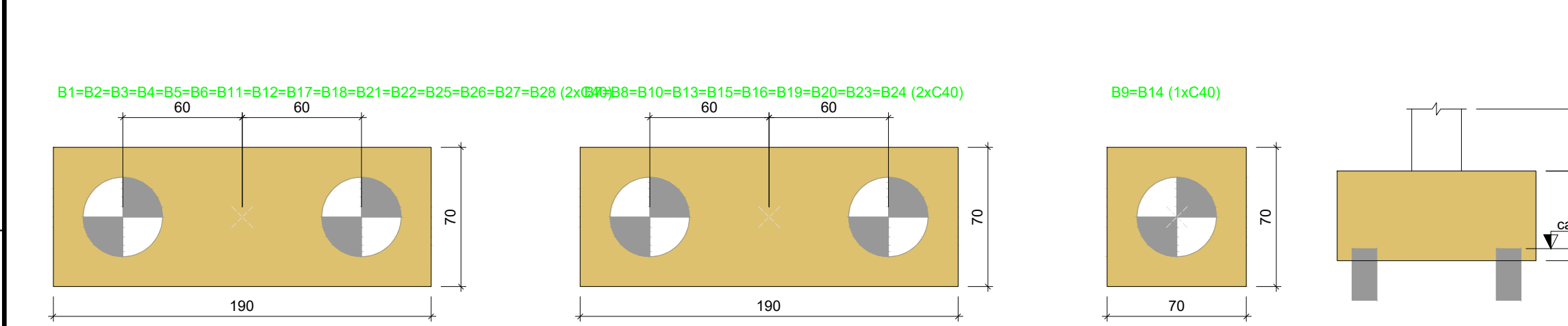

LEGENDA DOS BLOCOS

Nome	Seção	X (m)	Y (m)	Carga Max. (kN)	Pilar	My Máximo (kN.m)	Fundação	Fx Máximo (kN)	Fy Máximo (kN)	Localização no eixo Y
B1*	-	-546.69	1763.28	48	48	0	1	0	0	1763.28 B1, E1, B2
B2*	-	-546.69	1763.28	48	48	0	1	0	0	1763.28 B1, E1, B2
B3*	-	-546.69	1763.28	48	48	0	1	0	0	1763.28 B1, E1, B2
B4*	-	-546.69	1763.28	48	48	0	1	0	0	1763.28 B1, E1, B2
B5*	-	-546.69	1763.28	48	48	0	1	0	0	1763.28 B1, E1, B2
B6*	-	-546.69	1763.28	48	48	0	1	0	0	1763.28 B1, E1, B2
B7*	-	-546.69	1763.28	48	48	0	1	0	0	1763.28 B1, E1, B2
B8*	-	-546.69	1763.28	48	48	0	1	0	0	1763.28 B1, E1, B2
B9*	-	-546.69	1763.28	48	48	0	1	0	0	1763.28 B1, E1, B2
B10*	-	-546.69	1763.28	48	48	0	1	0	0	1763.28 B1, E1, B2
B11*	-	-546.69	1763.28	48	48	0	1	0	0	1763.28 B1, E1, B2
B12*	-	-546.69	1763.28	48	48	0	1	0	0	1763.28 B1, E1, B2
B13*	-	-546.69	1763.28	48	48	0	1	0	0	1763.28 B1, E1, B2
B14*	-	-546.69	1763.28	48	48	0	1	0	0	1763.28 B1, E1, B2
B15*	-	-546.69	1763.28	48	48	0	1	0	0	1763.28 B1, E1, B2
B16*	-	-546.69	1763.28	48	48	0	1	0	0	1763.28 B1, E1, B2
B17*	-	-546.69	1763.28	48	48	0	1	0	0	1763.28 B1, E1, B2
B18*	-	-546.69	1763.28	48	48	0	1	0	0	1763.28 B1, E1, B2
B19*	-	-546.69	1763.28	48	48	0	1	0	0	1763.28 B1, E1, B2
B20*	-	-546.69	1763.28	48	48	0	1	0	0	1763.28 B1, E1, B2
B21*	-	-546.69	1763.28	48	48	0	1	0	0	1763.28 B1, E1, B2
B22*	-	-546.69	1763.28	48	48	0	1	0	0	1763.28 B1, E1, B2
B23*	-	-546.69	1763.28	48	48	0	1	0	0	1763.28 B1, E1, B2
B24*	-	-546.69	1763.28	48	48	0	1	0	0	1763.28 B1, E1, B2
B25*	-	-546.69	1763.28	48	48	0	1	0	0	1763.28 B1, E1, B2
B26*	-	-546.69	1763.28	48	48	0	1	0	0	1763.28 B1, E1, B2
B27*	-	-546.69	1763.28	48	48	0	1	0	0	1763.28 B1, E1, B2
B28*	-	-546.69	1763.28	48	48	0	1	0	0	1763.28 B1, E1, B2
B29*	-	-546.69	1763.28	48	48	0	1	0	0	1763.28 B1, E1, B2
B30*	-	-546.69	1763.28	48	48	0	1	0	0	1763.28 B1, E1, B2
B31*	-	-546.69	1763.28	48	48	0	1	0	0	1763.28 B1, E1, B2
B32*	-	-546.69	1763.28	48	48	0	1	0	0	1763.28 B1, E1, B2
B33*	-	-546.69	1763.28	48	48	0	1	0	0	1763.28 B1, E1, B2
B34*	-	-546.69	1763.28	48	48	0	1	0	0	1763.28 B1, E1, B2
B35*	-	-546.69	1763.28	48	48	0	1	0	0	1763.28 B1, E1, B2
B36*	-	-546.69	1763.28	48	48	0	1	0	0	1763.28 B1, E1, B2
B37*	-	-546.69	1763.28	48	48	0	1	0	0	1763.28 B1, E1, B2
B38*	-	-546.69	1763.28	48	48	0	1	0	0	1763.28 B1, E1, B2
B39*	-	-546.69	1763.28	48	48	0	1	0	0	1763.28 B1, E1, B2
B40*	-	-546.69	1763.28	48	48	0	1	0	0	1763.28 B1, E1, B2
B41*	-	-546.69	1763.28	48	48	0	1	0	0	1763.28 B1, E1, B2
B42*	-	-546.69	1763.28	48	48	0	1	0	0	1763.28 B1, E1, B2
B43*	-	-546.69	1763.28	48	48	0	1	0	0	1763.28 B1, E1, B2
B44*	-	-546.69	1763.28	48	48	0	1	0	0	1763.28 B1, E1, B2
B45*	-	-546.69	1763.28	48	48	0	1	0	0	1763.28 B1, E1, B2
B46*	-	-546.69	1763.28	48	48	0	1	0	0	1763.28 B1, E1, B2
B47*	-	-546.69	1763.28	48	48	0	1	0	0	1763.28 B1, E1, B2
B48*	-	-546.69	1763.28	48	48	0	1	0	0	1763.28 B1, E1, B2
B49*	-	-546.69	1763.28	48	48	0	1	0	0	1763.28 B1, E1, B2
B50*	-	-546.69	1763.28	48	48	0	1	0	0	1763.28 B1, E1, B2
B51*	-	-546.69	1763.28	48	48	0	1	0	0	1763.28 B1, E1, B2
B52*	-	-546.69	1763.28	48	48	0	1	0	0	1763.28 B1, E1, B2
B53*	-	-546.69	1763.28	48	48	0	1	0	0	1763.28 B1, E1, B2
B54*	-	-546.69	1763.28	48	48	0	1	0	0	1763.28 B1, E1, B2
B55*	-	-546.69	1763.28	48	48	0	1	0	0	1763.28 B1, E1, B2
B56*	-	-546.69	1763.28	48	48	0	1	0	0	1763.28 B1, E1, B2
B57*	-	-546.69	1763.28	48	48	0	1	0	0	1763.28 B1, E1, B2
B58*	-	-546.69	1763.28	48	48	0	1	0	0	1763.28 B1, E1, B2
B59*	-	-546.69	1763.28	48	48	0	1	0	0	1763.28 B1, E1, B2
B60*	-	-546.69	1763.28	48	48	0	1	0	0	1763.28 B1, E1, B2
B61*	-	-546.69	1763.28	48	48	0	1	0	0	1763.28 B1, E1, B2
B62*	-	-546.69	1763.28	48	48	0	1	0	0	1763.28 B1, E1, B2
B63*	-	-546.69	1763.28	48	48	0	1	0	0	1763.28 B1, E1, B2
B64*	-	-546.69	1763.28	48	48	0	1	0	0	1763.28 B1, E1, B2
B65*	-	-546.69	1763.28	48	48	0	1	0	0	1763.28 B1, E1, B2
B66*	-	-546.69	1763.28	48	48	0	1	0	0	1763.28 B1, E1, B2
B67*	-	-546.69	1763.28	48	48	0	1	0	0	1763.28 B1, E1, B2
B68*	-	-546.69	1763.28	48	48	0	1	0	0	1763.28 B1, E1, B2
B69*	-	-546.69	1763.28	48	48	0	1	0	0	1763.28 B1, E1, B2
B70*	-	-546.69	1763.28	48	48	0	1	0	0	1763.28 B1, E1, B2
B71*	-	-546.69	1763.28	48	48	0	1	0	0	1763.28 B1, E1, B2
B72*	-	-546.69	1763.28	48	48	0	1	0	0	1763.28 B1, E1, B2
B73*	-	-546.69	1763.28	48	48	0	1	0	0	1763.28 B1, E1, B2
B74*	-	-546.69	1763.28	48	48	0	1	0	0	1763.28 B1, E1, B2
B75*	-	-546.69	1763.28	48	48	0	1	0	0	1763.28 B1, E1, B2
B76*	-	-546.69	1763.28	48	48	0	1	0	0	1763.28 B1, E1, B2
B77*	-	-546.69	1763.28	48	48	0	1	0	0	1763.28 B1, E1, B2
B78*	-	-546.69	1763.28	48	48	0	1	0	0	1763.28 B1, E1, B2
B79*	-	-546.69	1763.28	48	48	0	1	0	0	1763.28 B1, E1, B2
B80*	-	-546.69	1763.28	48	48	0	1	0	0	1763.28 B1, E1, B2
B81*	-	-546.69	1763.28	48	48	0	1	0	0	1763.28 B1, E1, B2
B82*	-	-546.69	1763.28	48	48	0	1	0	0	1763.28 B1, E1, B2
B83*	-	-546.69	1763.28	48	48	0	1	0	0	1763.28 B1, E1, B2
B84*	-	-546.69	1763.28	48	48	0	1	0	0	1763.28 B1, E1, B2
B85*	-	-546.69	1763.28	48	48	0	1	0	0	1763.28 B1, E1, B2
B86*	-	-546.69	1763.28	48	48	0	1	0	0	1763.28 B1, E1, B2
B87*	-	-546.69	1763.28	48	48	0	1	0	0	1763.28 B1, E1, B2
B88*	-	-546.69	1763.28	48	48	0	1	0	0	1763.28 B1, E1, B2
B89*	-	-546.69	1763.28	48	48	0	1	0	0	1763.28 B1, E1, B2
B90*	-	-546.69	1763.28	48	48	0	1	0	0	1763.28 B1, E1, B2
B91*	-	-546.69	1763.28	48	48	0	1	0	0	1763.28 B1, E1, B2
B92*	-	-546.69	1763.28	48	48	0	1	0	0	1763.28 B1, E1, B2
B93*	-	-546.69	1763.28	48	48	0	1	0	0	1763.28 B1, E1, B2
B94*	-	-546.69	1763.28	48	48	0	1	0	0	1763.28 B1, E1, B2
B95*	-	-546.69	1763.28	48	48	0	1	0	0	1763.28 B1, E1, B2
B96*	-	-546.69	1763.28	48	48	0	1	0	0	1763.28 B1, E1, B2
B97*	-	-546.69	1763.28	48	48	0	1	0	0	1763.28 B1, E1, B2
B98*	-	-546.69	1763.28	48	48	0	1	0	0	1763.28 B1, E1, B2
B99*	-	-546.69	1763.28	48	48	0	1	0	0	1763.28 B1, E1, B2
B100*	-	-546.69	1763.28	48	48	0	1	0	0	1763.28 B1, E1, B2

Simbologia	Estacas	Quantidade
C40	40.00	54
E40-2MT	40.00	16

Coordenadas (m)	Nome
-891.24	E13
-546.69	E1, B3, B5, B11, B17, B21, B25, B27
-351.44	E11, E15
-95.39	E1, E2, E3, E4, E6, E8, E9, E10
158.92	E12, E16
353.26	B2, B4, B6, B12, B18, B22, B26, B28
573.51	P10, P14
578.01	P7, P15, P23
578.51	P19
703.76	E14
770.01	E5
789.76	E7
901.26	P5, P13, P16, P20
903.76	P6, P24

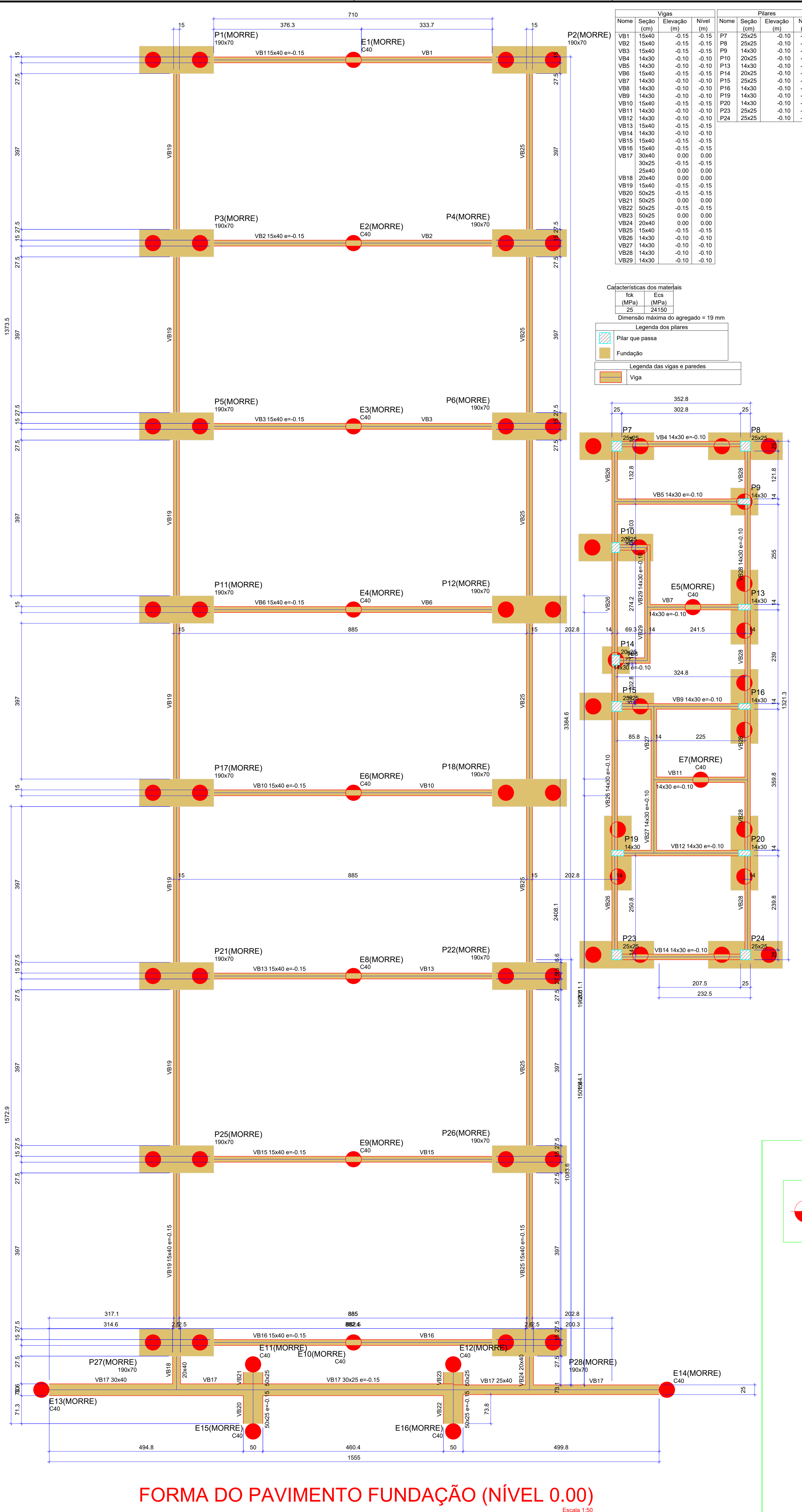

FORMA DO PAVIMENTO FUNDAÇÃO (NÍVEL 0.00)



DETALHAMENTO DAS ESTACAS Ø 30cm

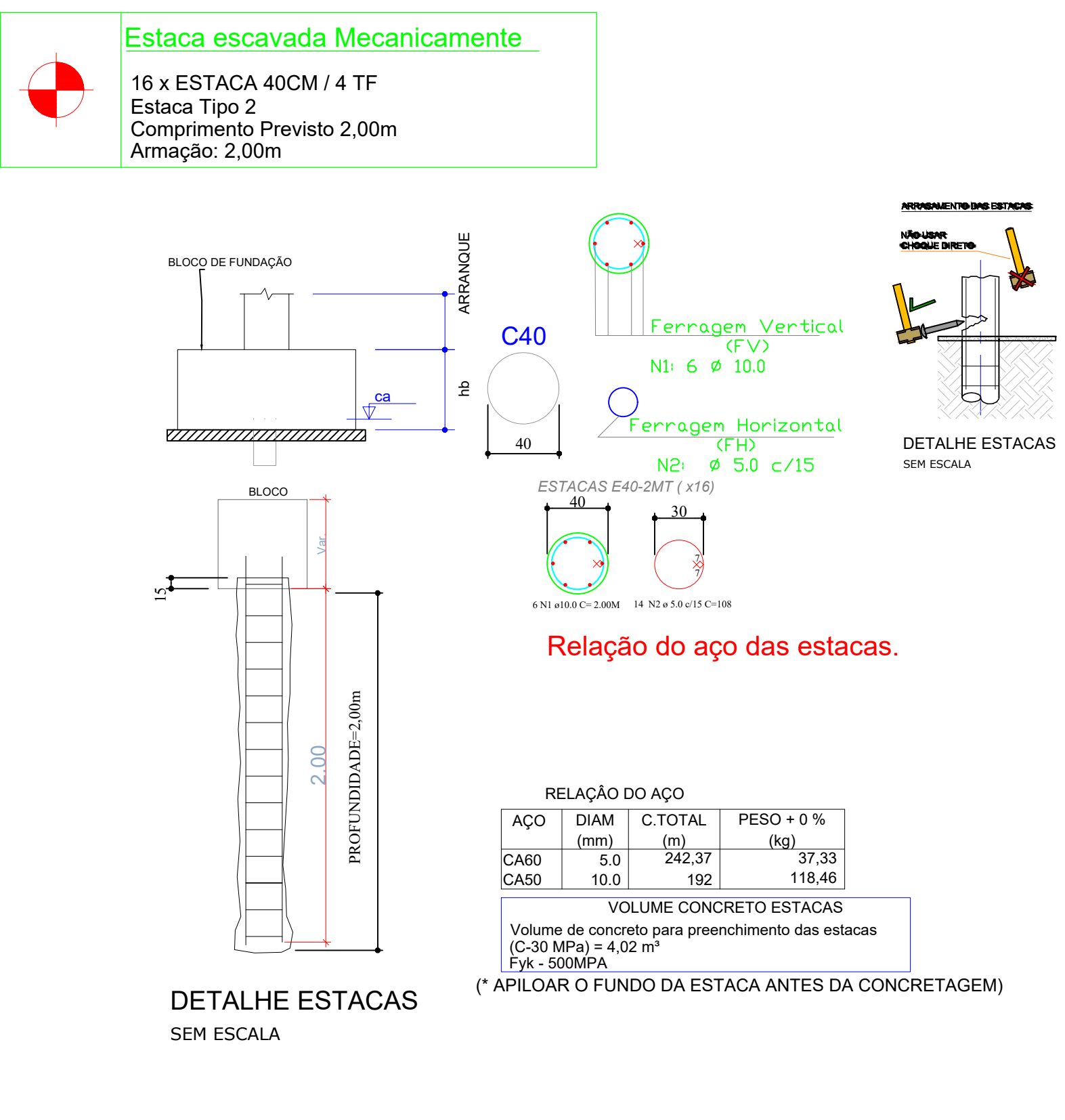

DETALHAMENTO DAS ESTACAS Ø 30cm

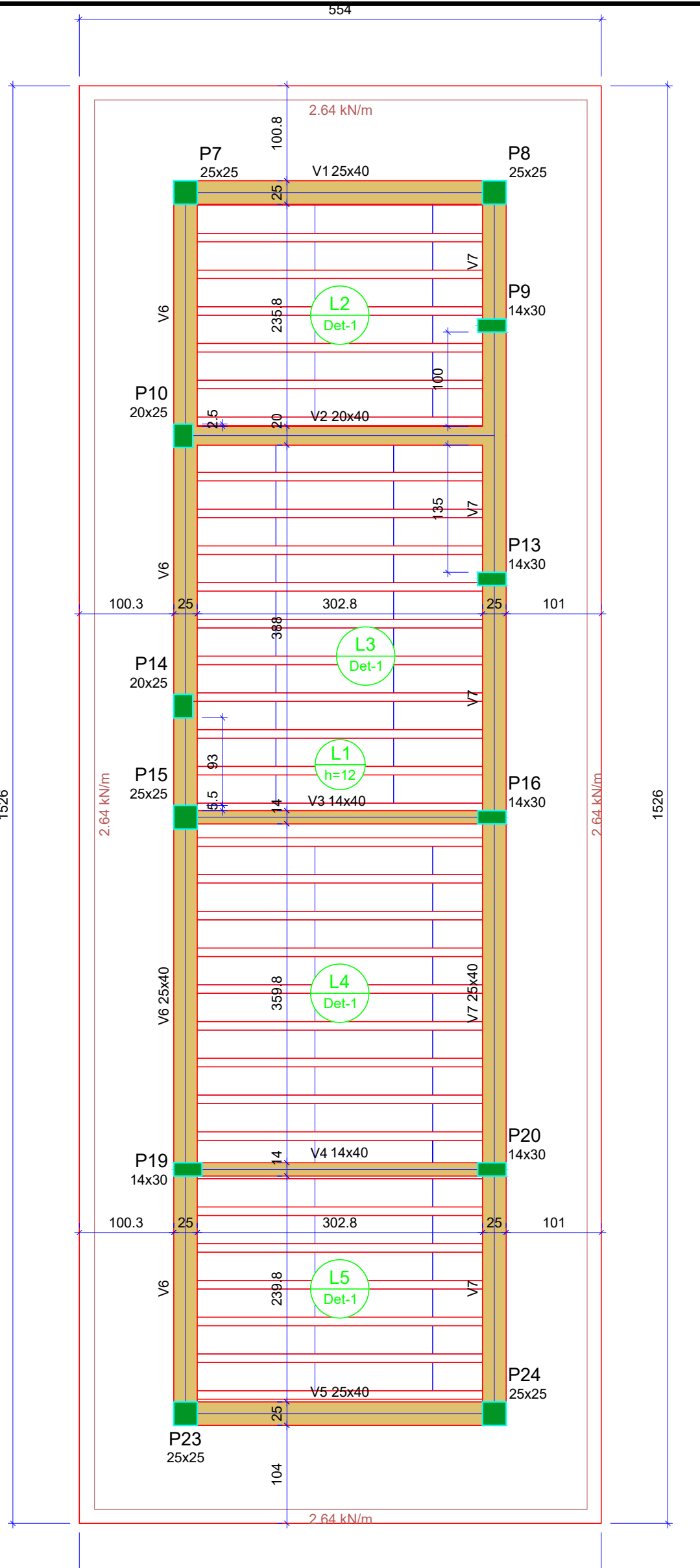
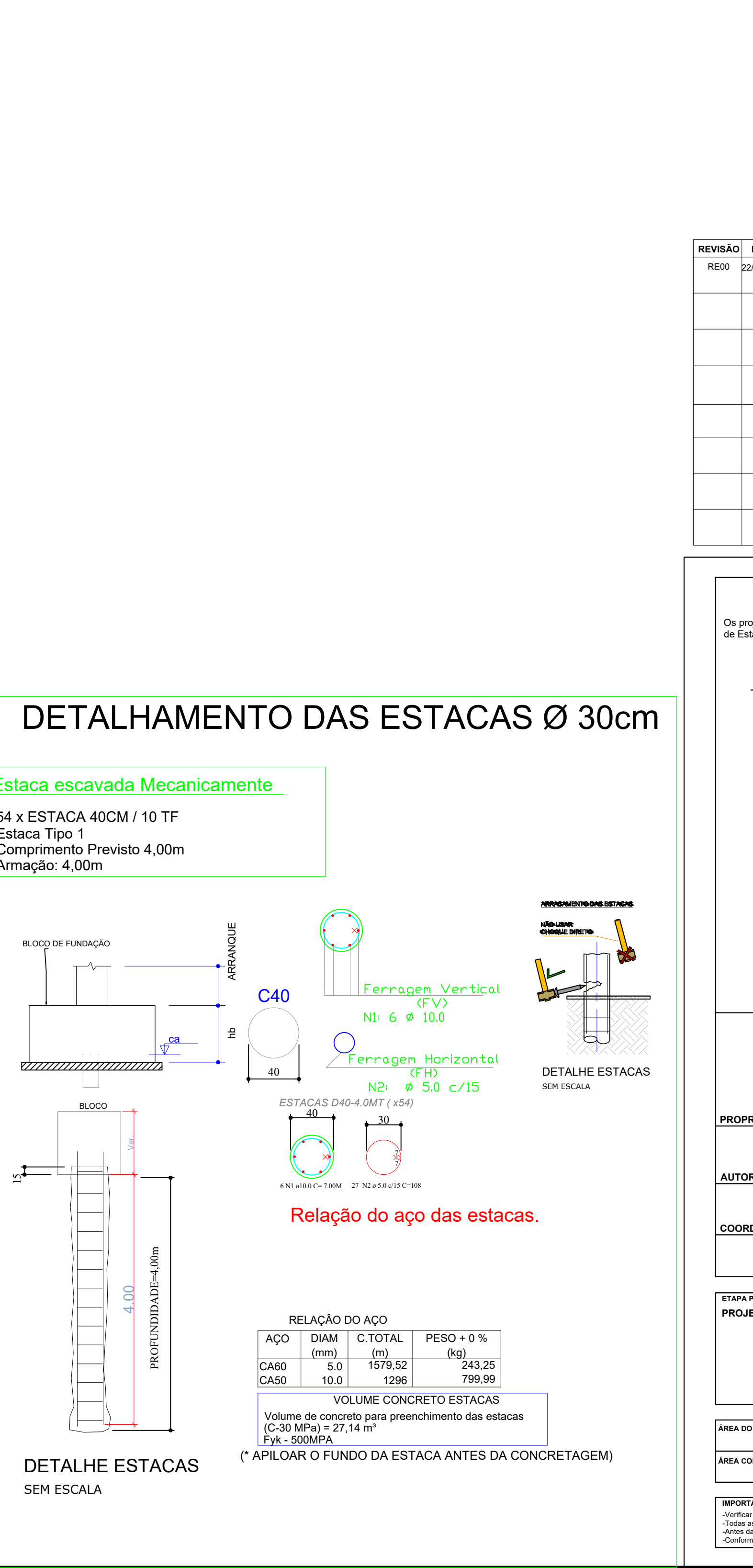

FORMA DO PAVIMENTO TÉRREO (NÍVEL 2.63)

REVISÃO	DATA	MOTIVAÇÃO	SOLICITANTE	CONTEÚDO	AUTOR
RE00	22/07/2025	Erro inicial dos Projetos	SEINFRA	PROJETO FEIRA COBERTA	Eng. Lucas

APROVAÇÃO DE PROJETOS

Os projetos referentes ao Processo SEI Nº 20250202000068, encontram-se dentro das normas e exigências da Secretaria de Estado de Infraestrutura - SEINFRA, tendo sido elaborado por profissionais habilitados.

SPOO - SUPERINTENDÊNCIA DE PROJETOS E ORGANIZADORES DE OBRAS

GEF - GERÊNCIA DE PROJETOS

GOIÁS

Secretaria de Estado de Infraestrutura

EDIFÍCIO THE PRIME TAMANDARÉ OFFICE

Rua 5, Nº 691 – 23º andar, Setor Oeste, Goiânia-GO – CEP 74.115-060

FUNDAÇÕES EM CONCRETO ARMADO

QD.50 LOTE Nº02, Setor Vila Progresso, Cachoeira de Goiás-GO

FEIRA COBERTA

LOCAÇÃO DE FUNDAÇÕES/ FORMAS

PROPRIETÁRIO

SECRETARIA DE ESTADO DA INFRAESTRUTURA - SEINFRA - CNPJ: 49.706.100/0001-90

AUTOR DO PROJETO

ENG. CIVIL LUCAS SOUSA ROCHA - CREA 10.19323337-D-GO

COORDENAÇÃO

ENG. CIVIL THIAGO ALVES SILVA - CREA 1004804750-D-GO

PLANO PROJETO

PROJETO EXECUTIVO

CONTEÚDO

Planta de Locação de Fundações

Planta de Formas

ÁREA DO TERRENO ORIGINAL

1.950,00m²

RESENDA

LUCIANO LARISSA

DATA

23/07/2025

RECALCULADO

RODRIGO

FOLHA

01/04

TOTAL

01/04